

Universal-joint Type Flat Spray Nozzles

UT+VP

Flat Spray

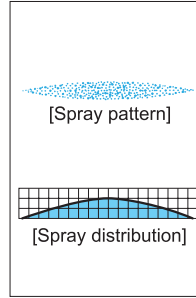

[Features]

- Flat spray pattern with a mountain-shaped spray distribution having gradually tapered edges.
- Spray direction is adjustable over a range of 40 degrees as desired.

[Standard pressure]

0.3 MPa

[Applications]

Cleaning: Automotives, containers, films, felts, filters, screens, bottles, crushed stones, earth and sand, metal parts, machines, steel plates, steel pieces
 Spraying: Oils, lubricants, liquids, solutions, insecticides, herbicides

UT+VP series

UT+VP series (with ceramic orifice inserted)										
Structure	<ul style="list-style-type: none"> • Includes a ceramic orifice in the nozzle tip. • Comprises three parts: Nozzle tip, cap, and adaptor. • Worn-out nozzle tip can be replaced. • Nozzle tip has integrated universal ball joint for adjusting spray direction. 									
Material	<ul style="list-style-type: none"> • Nozzle orifice: ceramic • Metal parts: S303 									
Pipe conn. size	Dimensions (mm)									Mass (g)
	L1	L2	H1	H2	W	øD1	øD2	øD3	N	
R1/4	57.5	37	29	24	11	32	26.5	13	10.5	120
R3/8	63.5	44	35	30	14	38.5	33	17	11	200

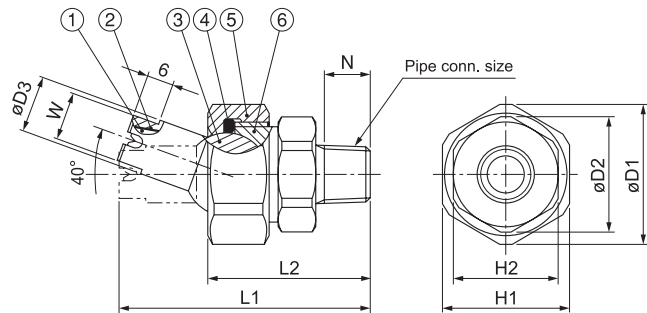

①Ceramic orifice ②Adhesive: Araldite® ③Ball
 ④O-ring (NBR) ⑤Cap ⑥Adaptor

[Note] Appearance and dimensions may differ slightly depending on materials and nozzle codes.

Spray angle code	Spray capacity code	Pipe conn. size		Spray angle (°)			Spray capacity (ℓ/min)							Free passage diameter (mm)	
		R1/4	R3/8	0.15 MPa	0.3 MPa	0.7 MPa	0.1 MPa	0.15 MPa	0.2 MPa	0.3 MPa	0.5 MPa	0.7 MPa	1 MPa		2 MPa
80	30	○		70	80	87	1.73	2.12	2.45	3.00	3.88	4.58	5.48	7.75	1.0
	50	○		71	80	86	2.89	3.54	4.08	5.00	6.46	7.64	9.13	12.9	1.4
	80	○		72	80	86	4.62	5.66	6.53	8.00	10.3	12.2	14.6	20.6	1.7
	100		○	72	80	85	5.77	7.07	8.17	10.0	12.9	15.3	18.3	25.8	2.0
	140		○	73	80	85	8.08	9.90	11.4	14.0	18.1	21.4	25.6	36.1	2.5
	170		○	73	80	85	9.82	12.0	13.9	17.0	22.0	26.0	31.1	43.9	2.7
65	30	○		56	65	72	1.73	2.12	2.45	3.00	3.88	4.58	5.48	7.75	1.1
	50	○		57	65	71	2.89	3.54	4.08	5.00	6.46	7.64	9.13	12.9	1.5
	80	○		58	65	71	4.62	5.66	6.53	8.00	10.3	12.2	14.6	20.6	1.9
	100		○	58	65	70	5.77	7.07	8.17	10.0	12.9	15.3	18.3	25.8	2.1
	140		○	59	65	69	8.08	9.90	11.4	14.0	18.1	21.4	25.6	36.1	2.5
	170		○	59	65	69	9.82	12.0	13.9	17.0	22.0	26.0	31.1	43.9	2.8
50	30	○		42	50	56	1.73	2.12	2.45	3.00	3.88	4.58	5.48	7.75	1.2
	50	○		43	50	55	2.89	3.54	4.08	5.00	6.46	7.64	9.13	12.9	1.6
	80	○		43	50	55	4.62	5.66	6.53	8.00	10.3	12.2	14.6	20.6	2.0
	100		○	44	50	54	5.77	7.07	8.17	10.0	12.9	15.3	18.3	25.8	2.2
	140		○	44	50	54	8.08	9.90	11.4	14.0	18.1	21.4	25.6	36.1	2.7
	170		○	45	50	54	9.82	12.0	13.9	17.0	22.0	26.0	31.1	43.9	3.0

[Note] 1. Spray nozzle performance is guaranteed only when the nozzle is set at no angle.
 2. For spray droplet diameter, please see the chart of VP series nozzles on page 19.

How to order

Please inquire or order for a specific nozzle using this coding system.

<Example> 1/4M UT+VP 8030 S303

1/4M **UT+VP** **80** **30** **S303**

Pipe conn. size*	Spray angle code	Spray capacity code
1/4M	80	30
3/8M	65	50
	50	170

Contact us if you want to order only nozzle tips.

**"M" indicates male thread ("R" of the ISO standard) and "F" indicates female thread ("Rc" of the ISO standard), e.g. 1/4M = R1/4.

ALSO AVAILABLE!

Universal-joint Type
Solid Stream Jet

UT+CP series

See p.108 of this catalog.